

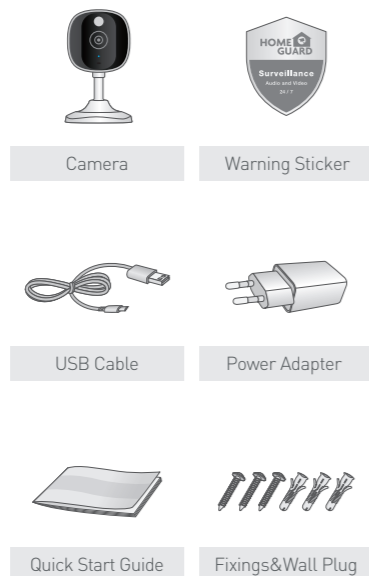

Stick Up AI Camera

Quick Start Guide - EN

What's included



Parts & Description

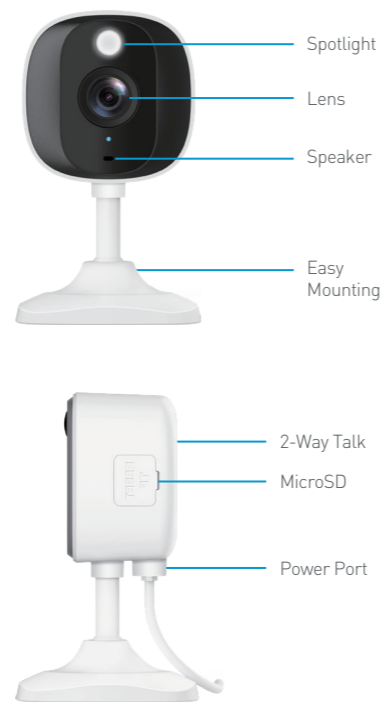

Power on Camera

1 Connect the AC adapter to your camera and plug it in.

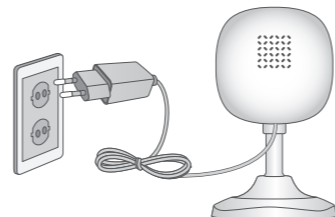

2 If you see the blue and red lights flashing, camera waiting to connect.



3 Make sure you are within range of the same Wi-Fi network you'll use for your camera.



Get the App

For the best experience, download the **Homeguardlive app** for your smartphone by scanning the QR code below or searching for "Homeguardlive" in the app store.



Account Register

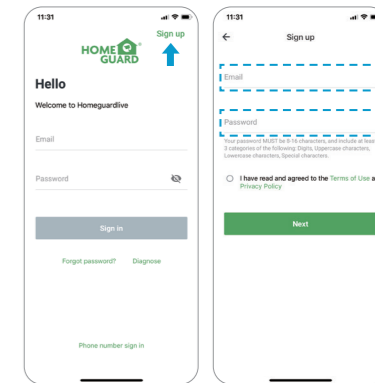

- 1 Open Homeguardlive App, then select Sign up.
- 2 Enter your email. Create a password at least 8 characters long. Your password must include three of the following:
 - At least one uppercase letter
 - At least one lowercase letter
 - At least one number
- 3 You will receive an email with your Activation Link. Open the link to activate your account. Go back to login your account after activation successful.

Add device

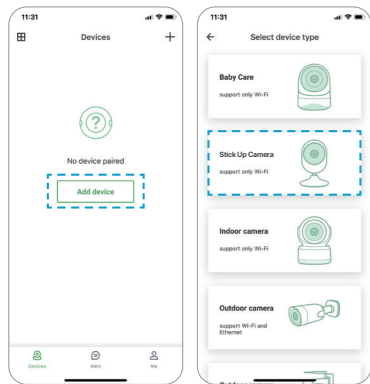

- 1 Login your account and tap "Add device".
- 2 Choose the "Stick Up Camera" to connect.
- 3 Check if the camera's indicator is flashing Blue and Red. If not, Please try to reset the camera.

Reset Method: Keep the camera powered on for more than 1 minute, then press and hold "Reset" button until the LED turns red.



8

Connect to Network

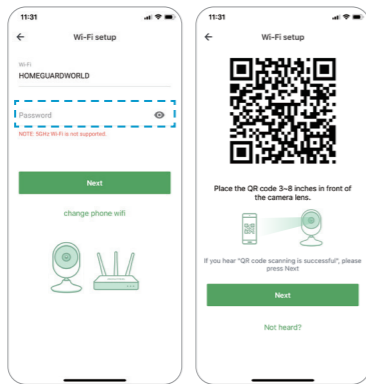

- 1 Enter the correct Wi-Fi password.
Note: The camera is not support 5GHz Wi-Fi.
- 2 This App will generate a QR code, place the QR code 3~8 inches in front of the camera lens. when the camera prompt "QR code scanning is successful", press "Next" and wait a moment.
- 3 Name the camera after the Pairing is successful. Press "OK" to complete the add operation.

9

You're Done!

Congratulations! Your Indoor Camera is set up and ready to go.

You are now free to position your camera anywhere in your home where you get a Wi-Fi signal and view it remotely from anywhere in the world on your Smartphone or Tablet!

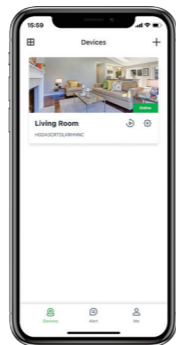

10

Home Page

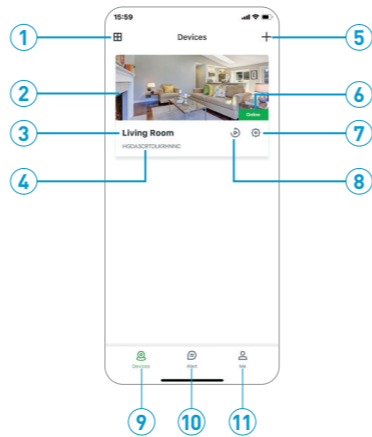

1	Split-screen	Tap to access Split-screen view
2	Live Video	Tap to start live view
3	Device name	Displays the camera name
4	Device ID	Displays the device cloud ID
5	Add Device	Tap to add a new camera
6	Device Status	Displays the camera network status
7	Setting	Tap to access camera setting
8	Replay	Tap to play the recorded video in the memory card
9	Devices	Tap to access device list page
10	Alerts	Tap to access alert information page
11	Me	Tap to access account information page

11

Live View

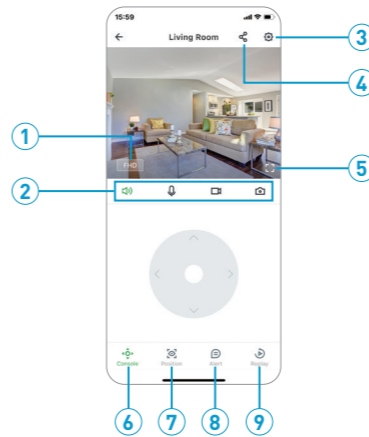

1	Resolution	Tap to change between video quality levels:SD,FHD
2	Mute / Unmute	Tap to hear the camera or unmute
	2-way talk	Activate the microphone to enable 2-way talk
	Record	Saves video clip from a live video
	Capture	Saves images captured from a live video
3	Setting	Tap to access camera setting
4	Share	Tap to share the camera to others
5	Full screen	Click to view in full screen
6	Console	Tap to enable pan & tilt controls
7	Position	Adds/Adjusts the preset & sets the home position
8	Alert	Tap to access alert list
9	Replay	Tap to play the recorded video in the memory card

12

Specifications

Hardware Features

- Wi-Fi Support
- Power Interface
- Reset Button
- Built-in microSD Socket
- Built-in Microphone and speaker
- 1x Integrated Spotlight
- 4 infrared LED, 8m Night Vision Range

Resolution

2304 × 1296

Compression / Max Frame Rate

H.265, 15fps

Image Sensor / Lens

1/3" CMOS Sensor, f=3.6mm,
F=2.1 Viewing Angle: 110°

Human / Pet Detection

Supported, Will Activate Camera

Security Protocols

WPA/WPA2, WPA-PSK/WPA2-PSK

Wireless Speed

IEEE802.11b/g/n 150Mbps

Camera Dimensions

56.8mm × 56.8mm × 96.3mm

Power Input

DC 5V / 1A, <1.9W



iGET HOMEGUARD 2024

www.iget.eu/cs/helpdesk-centrum-cs

https://helpdesk.intelek.cz



Made in China

13